



CONSTRUCTION NOTICE

March 2018

Beacon Hill Path crossing improvements starting as early as Monday, March 11

PROJECT OVERVIEW

We will begin installing crossing improvements on the path at Beacon Ave S/S Morgan St as soon as Monday, March 11. Once we have completed the work at Beacon Ave S/S Morgan St, we will begin work at Beacon Ave S/S Warsaw St. This work is expected to last approximately 4-6 weeks and is weather dependent. To complete the work safely and efficiently, we will close S Morgan St between the northbound and southbound lanes of Beacon Ave S. We will follow the same process for work at S Warsaw St. We will also remove 3 trees: 1 at Beacon Ave S/S Morgan St and 2 at Beacon Ave S/S Warsaw St.

Thank you in advance for your patience during this work!

WHAT TO EXPECT

During this work, please expect:

- Temporary street closures at S Morgan St and S Warsaw St
- Temporary and intermittent traffic and lane restrictions and/or pedestrian detours; signage and flaggers to direct people around the work zone
- Equipment, materials, and noise near the project area
- "No Park" signs in work area 72 hours in advance of work

PROJECT CONTACT

Maribel Cruz, Outreach Lead
NeighborhoodImprovements2018@seattle.gov
(206) 500-8725



Seattle Department of Transportation



CONSTRUCTION NOTICE

March 2018

Beacon Ave S Path crossing improvements starting as early as Monday, March 11

PROJECT OVERVIEW

We will begin installing crossing improvements on the path at Beacon Ave S/S Morgan St as soon as Monday, March 11. Once we have completed the work at Beacon Ave S/S Morgan St, we will begin work at Beacon Ave S/S Warsaw St. This work is expected to last approximately 4-6 weeks and is weather dependent. To complete the work safely and efficiently, we will close S Morgan St between the northbound and southbound lanes of Beacon Ave S. We will follow the same process for work at S Warsaw St. We will also remove 3 trees: 1 at Beacon Ave S/S Morgan St and 2 at Beacon Ave S/S Warsaw St.

Thank you in advance for your patience during this work!

WHAT TO EXPECT

During this work, please expect:

- Temporary street closures at S Morgan St and S Warsaw St
- Temporary and intermittent traffic and lane restrictions and/or pedestrian detours; signage and flaggers to direct people around the work zone
- Equipment, materials, and noise near the project area
- "No Park" signs in work area 72 hours in advance of work

PROJECT CONTACT

Maribel Cruz, Outreach Lead
NeighborhoodImprovements2018@seattle.gov
(206) 500-8725



Seattle Department of Transportation

PROJECT MAP

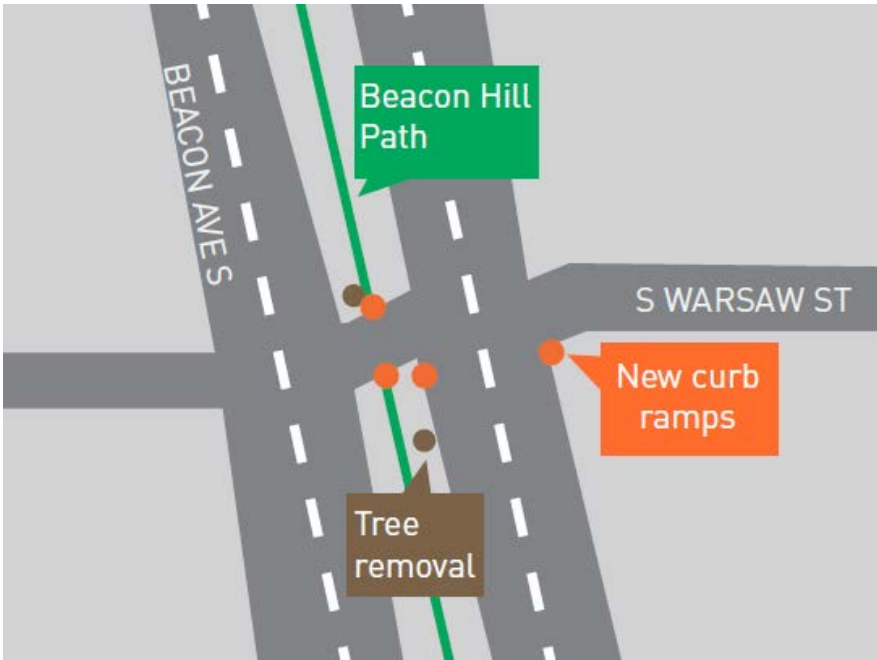

Improvements at Beacon Ave S/S Warsaw St. Similar improvements are planned at Beacon Ave S/S Morgan St. Image not to scale.

If you need this information translated, please call (206) 900-8725.

Servicios de traducción e interpretación disponibles bajo petición (206) 900-8725.

Dịch và thông dịch viên sẵn sàng nếu có sự yêu cầu (206) 900-8725.

如果您需要此信息翻譯成中文請致電 (206) 900-8725.

요청하시면 번역이나 통역을 제공해드립니다 (206) 900-8725.

Haddii aad dooneyso turjubeen fadlen wac (206) 900-8725.

Matutulungan ka naming maintindihan kung hihingi kang tulong (206) 900-8725.

ስለ ፕሮጀክቱ የበለጠ ለማወቅ ወይም ትርጉም አገልግሎት ለማግኘት ጥያቄ ለማቅረብ ወደዚህ ይደውሉ : (206) 900-8725.

PROJECT MAP

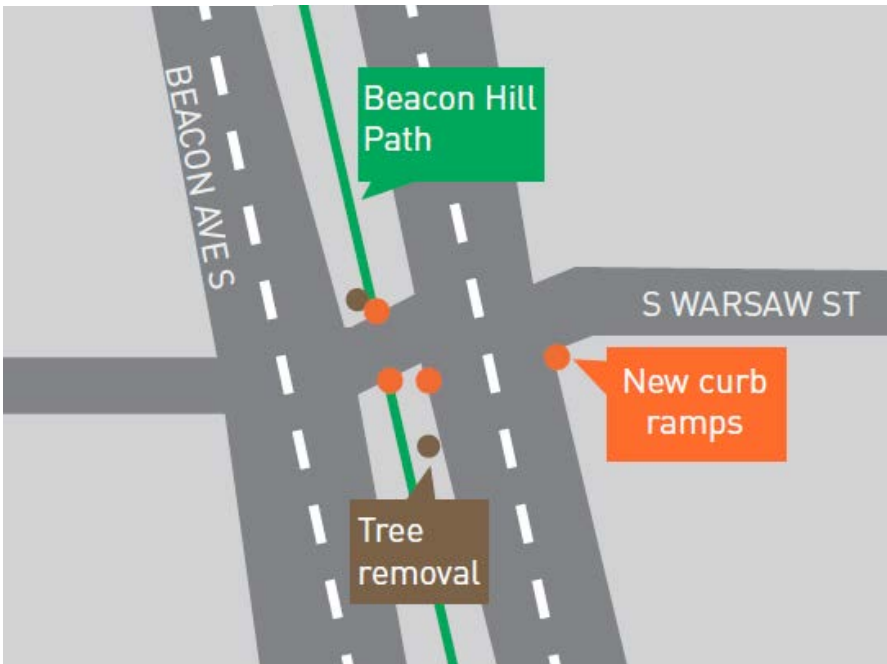

Improvements at Beacon Ave S/S Warsaw St. Similar improvements are planned at Beacon Ave S/S Morgan St. Image not to scale.

If you need this information translated, please call (206) 900-8725.

Servicios de traducción e interpretación disponibles bajo petición (206) 900-8725.

Dịch và thông dịch viên sẵn sàng nếu có sự yêu cầu (206) 900-8725.

如果您需要此信息翻譯成中文請致電 (206) 900-8725.

요청하시면 번역이나 통역을 제공해드립니다 (206) 900-8725.

Haddii aad dooneyso turjubeen fadlen wac (206) 900-8725.

Matutulungan ka naming maintindihan kung hihingi kang tulong (206) 900-8725.

ስለ ፕሮጀክቱ የበለጠ ለማወቅ ወይም ትርጉም አገልግሎት ለማግኘት ጥያቄ ለማቅረብ ወደዚህ ይደውሉ : (206) 900-8725.